

YMER

Montageanleitung

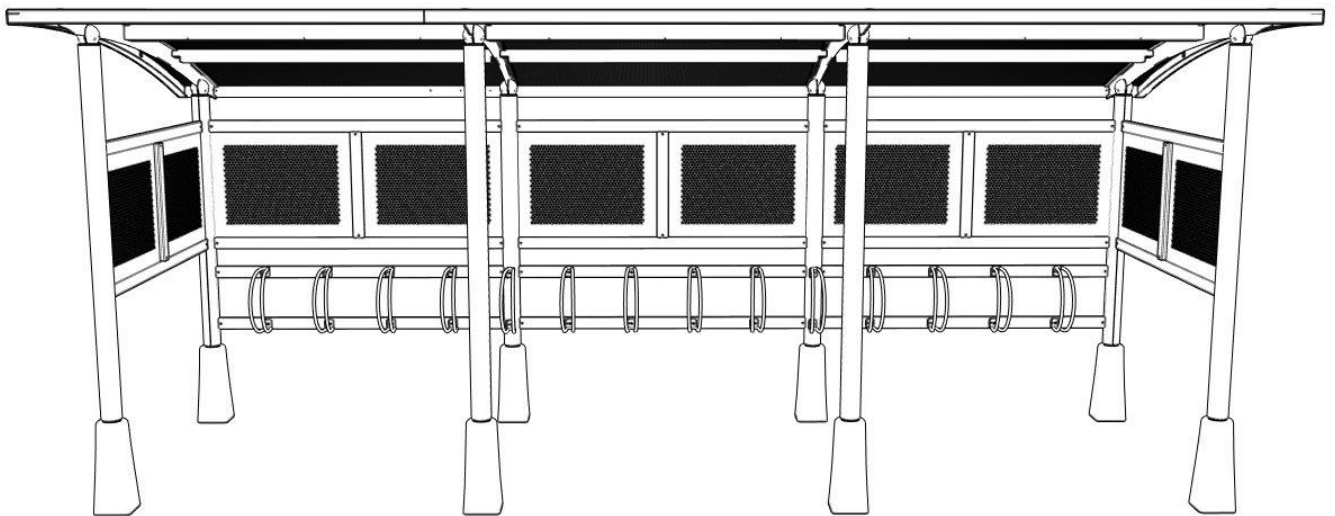

WELAND GmbH

SPENGLERSTRASSE 89-91, 23556 LÜBECK
TEL +49 451899410 info@weland.de

Toleranzen zur Installation von
Betongplint 500 beachten.

Höhe +/- 5 mm

Länge über alles +/- 5 mm

1A

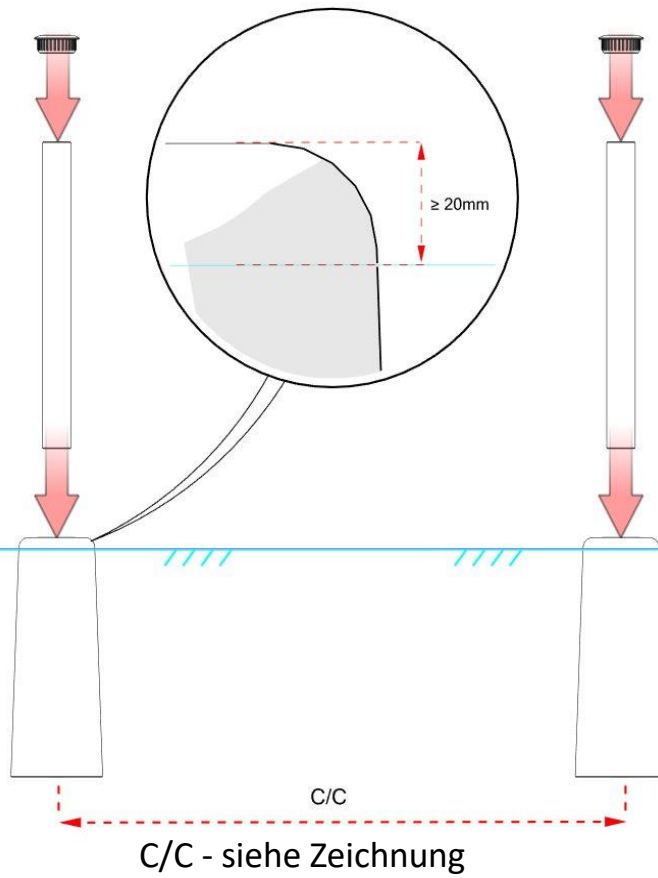

1B

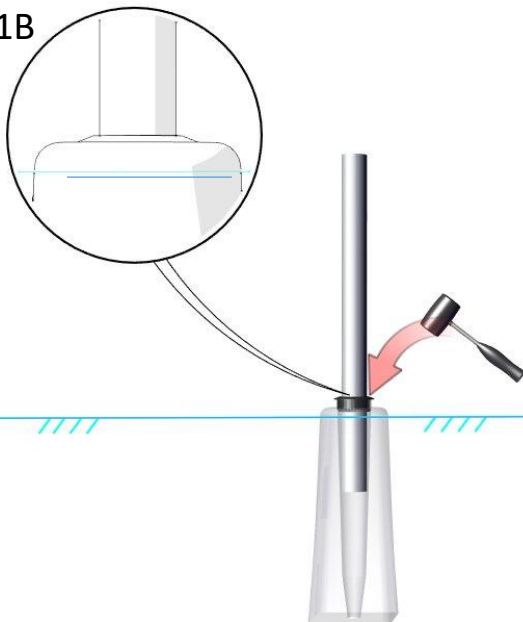

1C

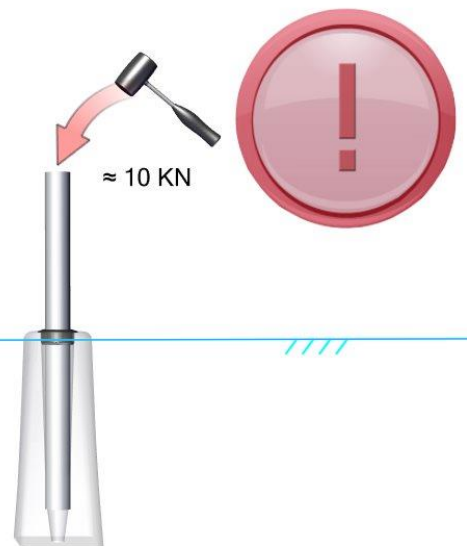

2

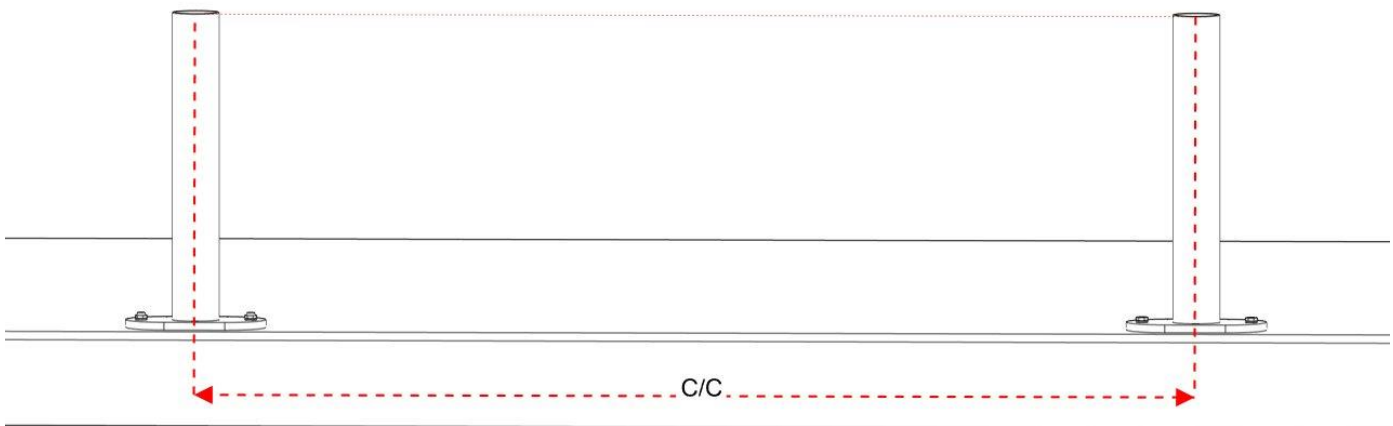
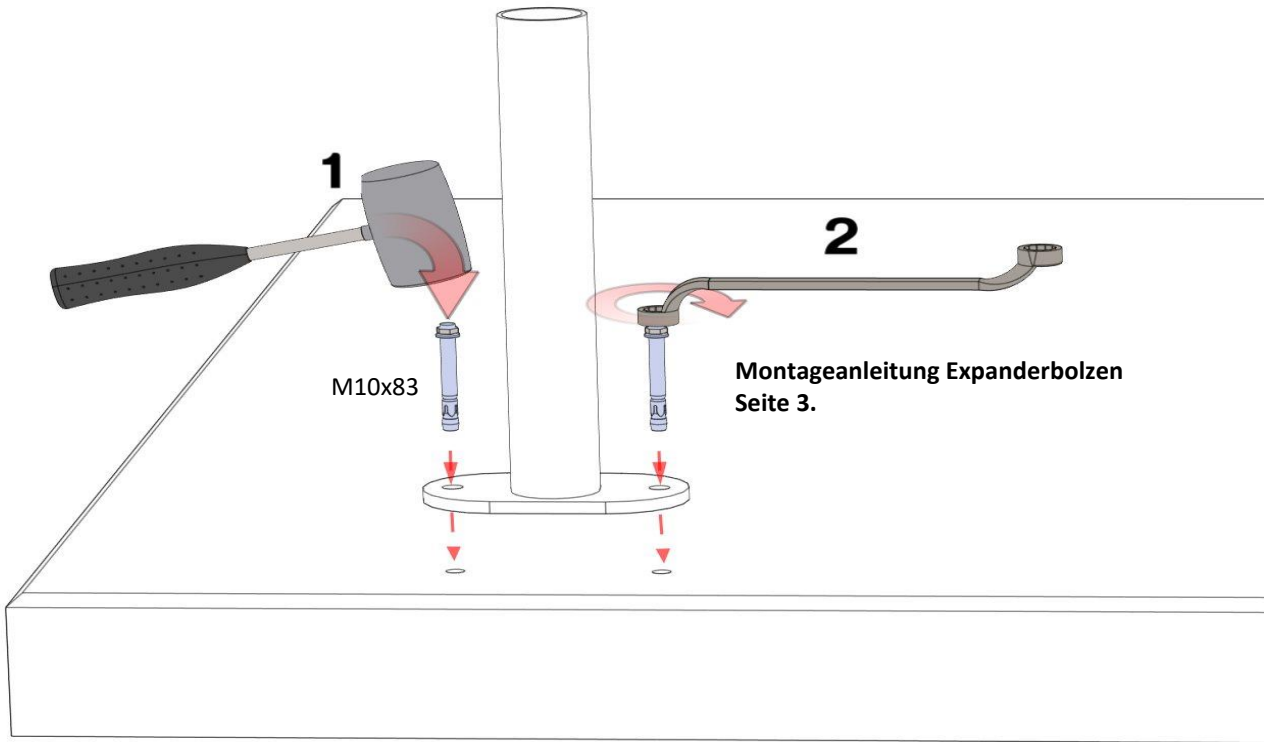

C/C - siehe Zeichnung

Montageanleitung Expanderbolzen HSA M10x83

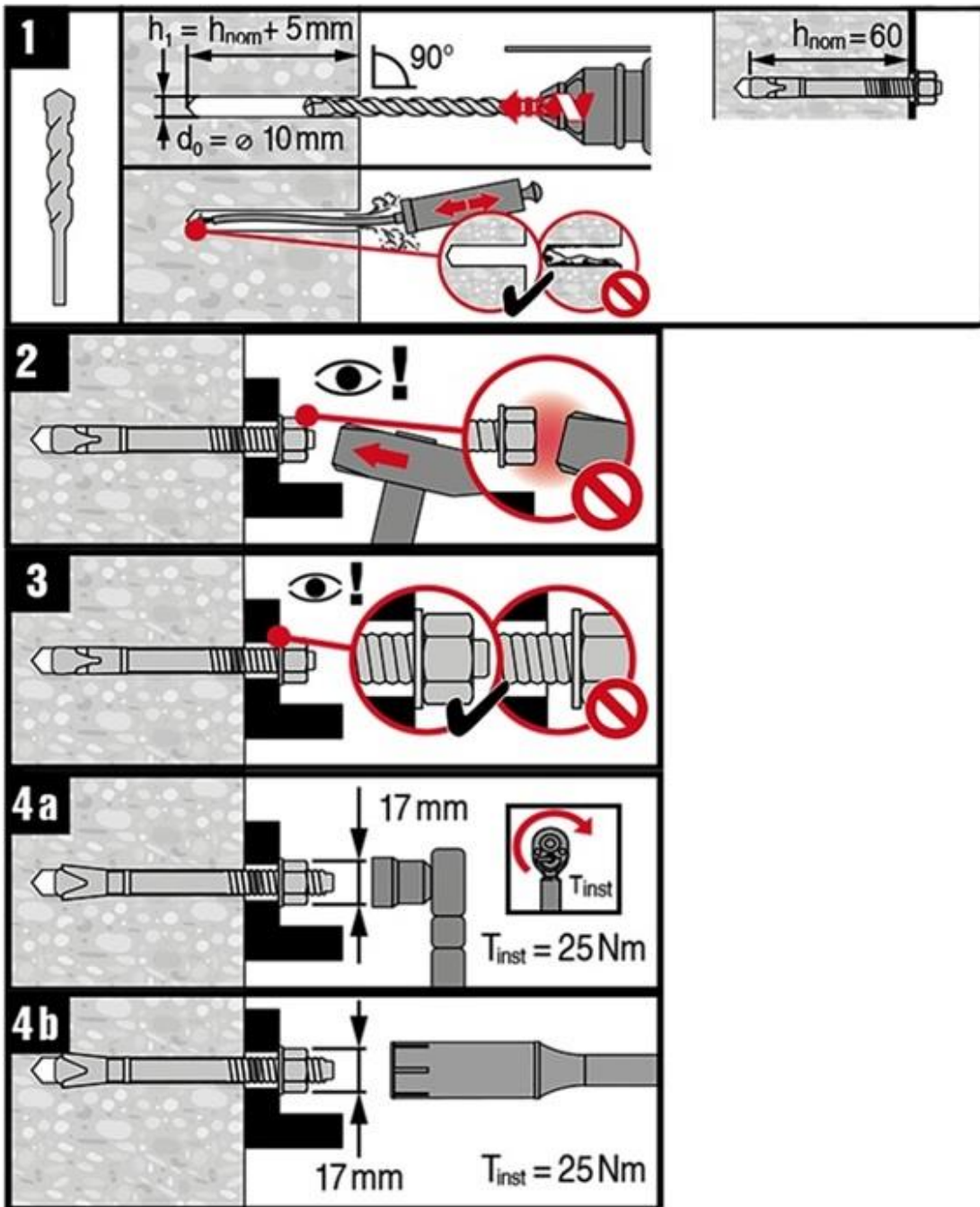

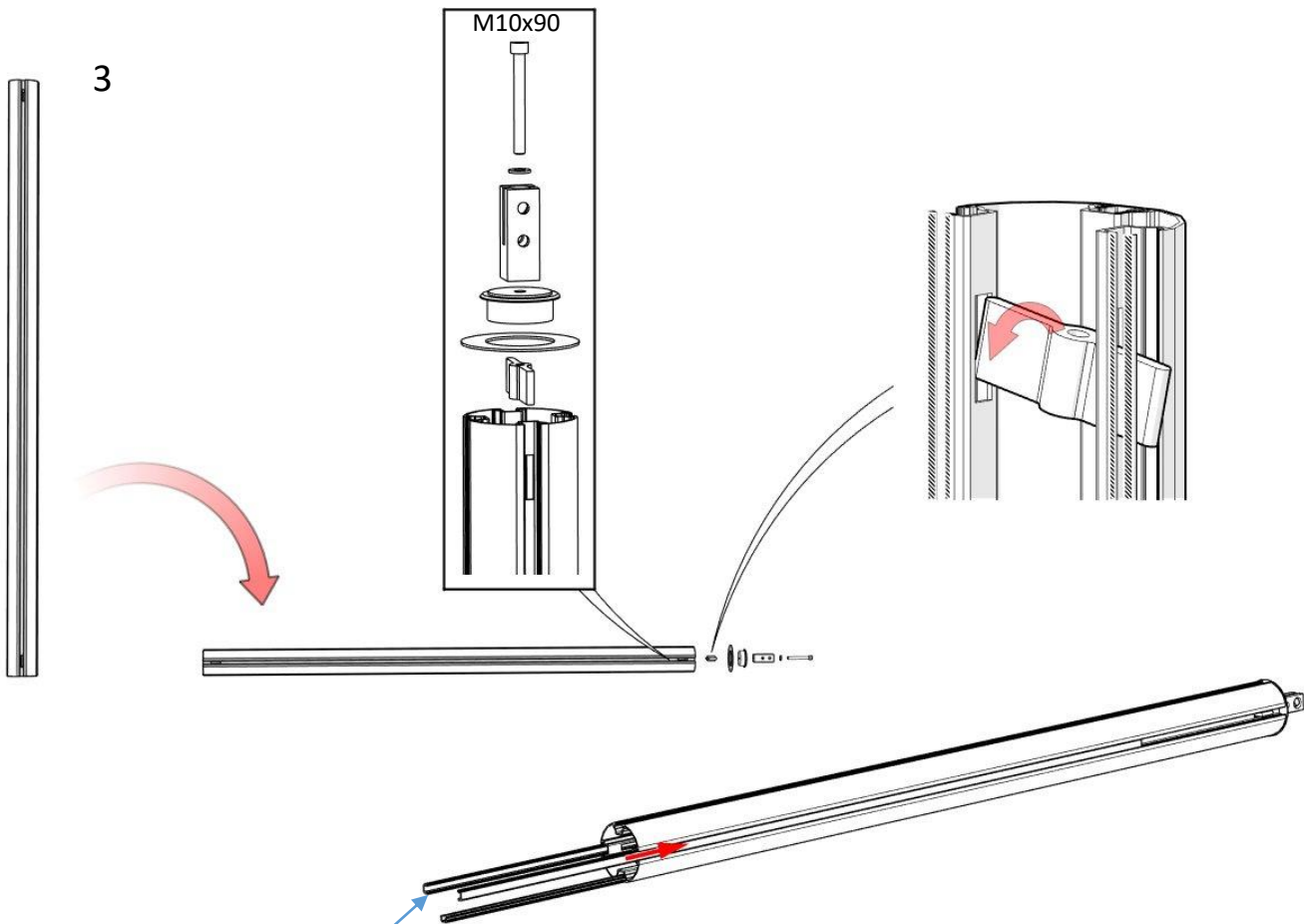

Darstellung zeigt die höhere Stütze nach erfolgter Montage

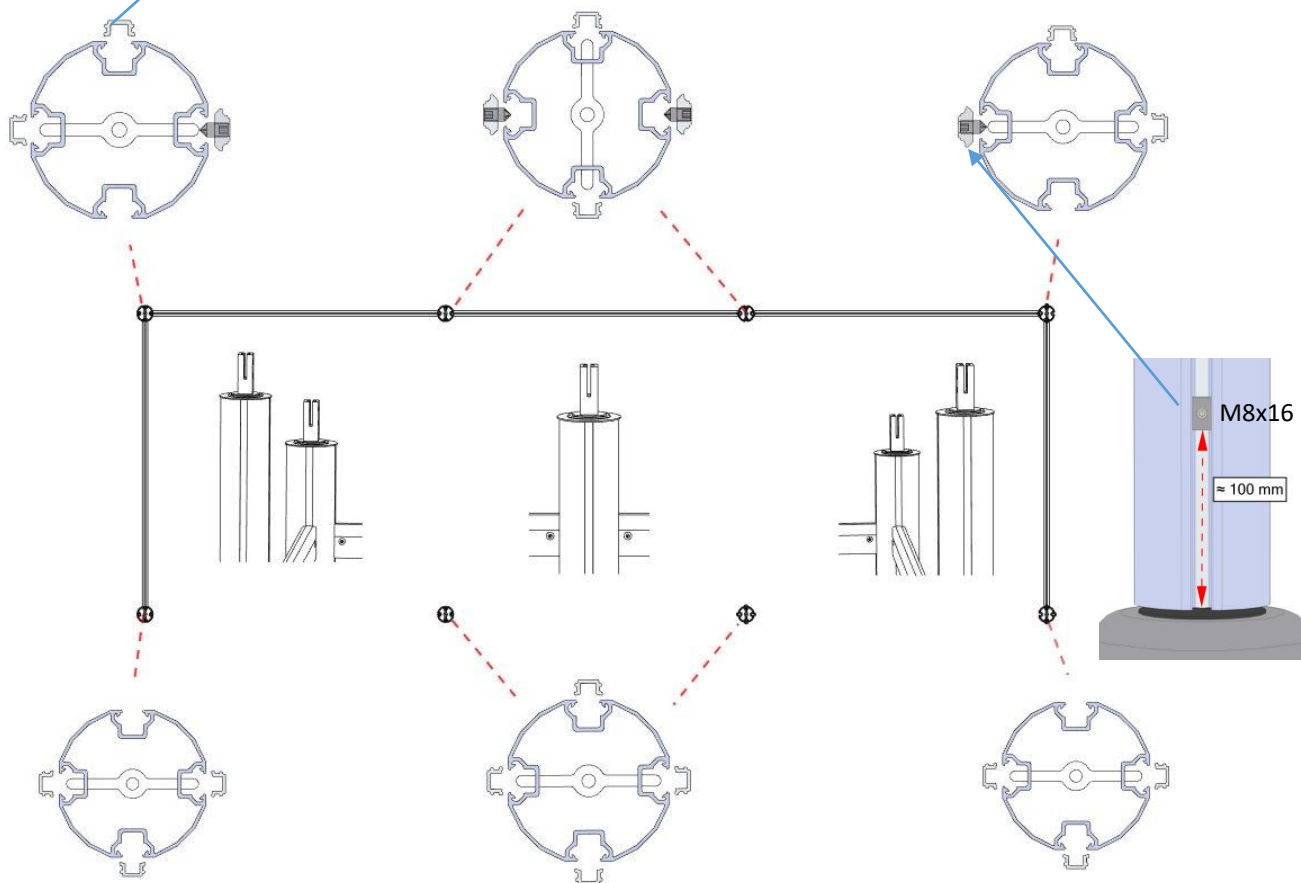

4

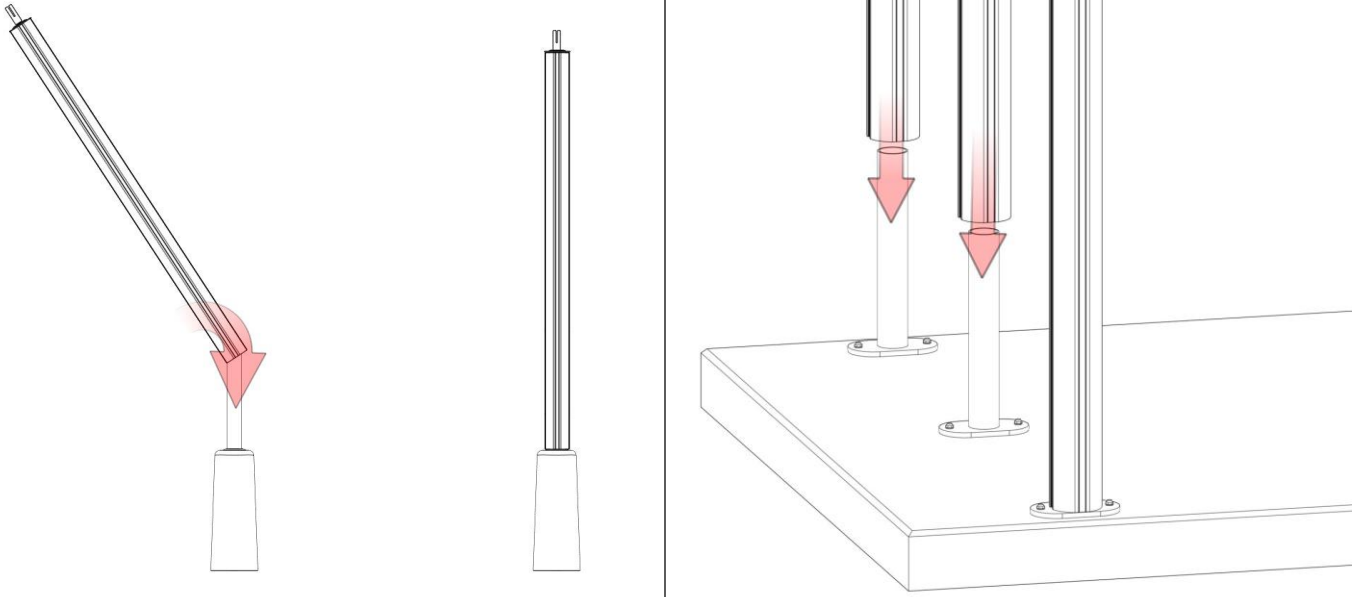

5

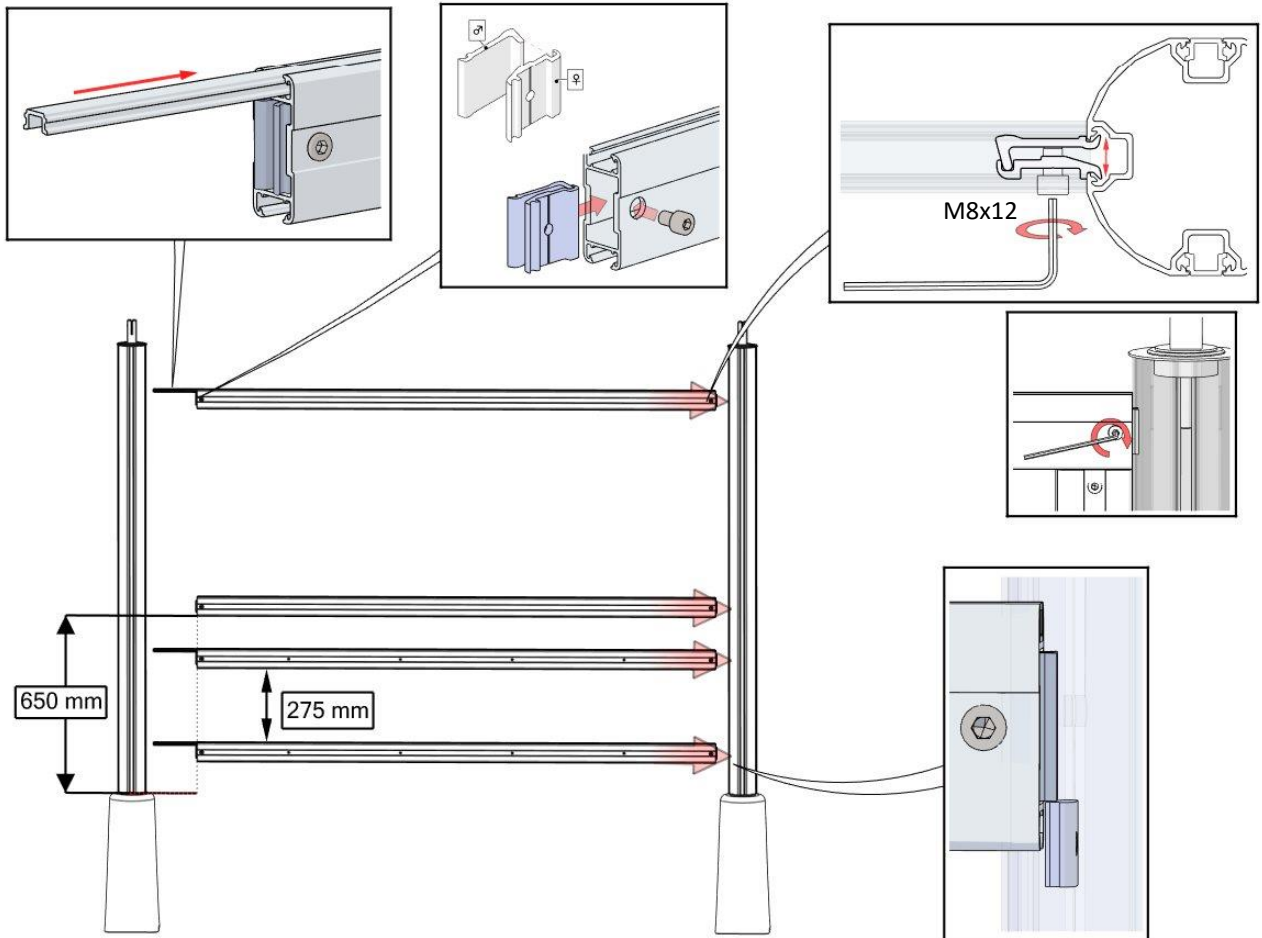

6

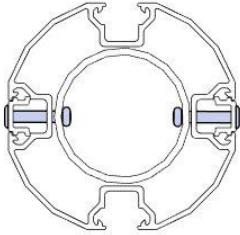
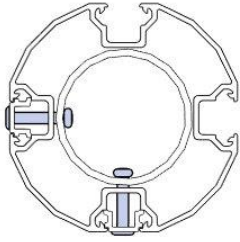
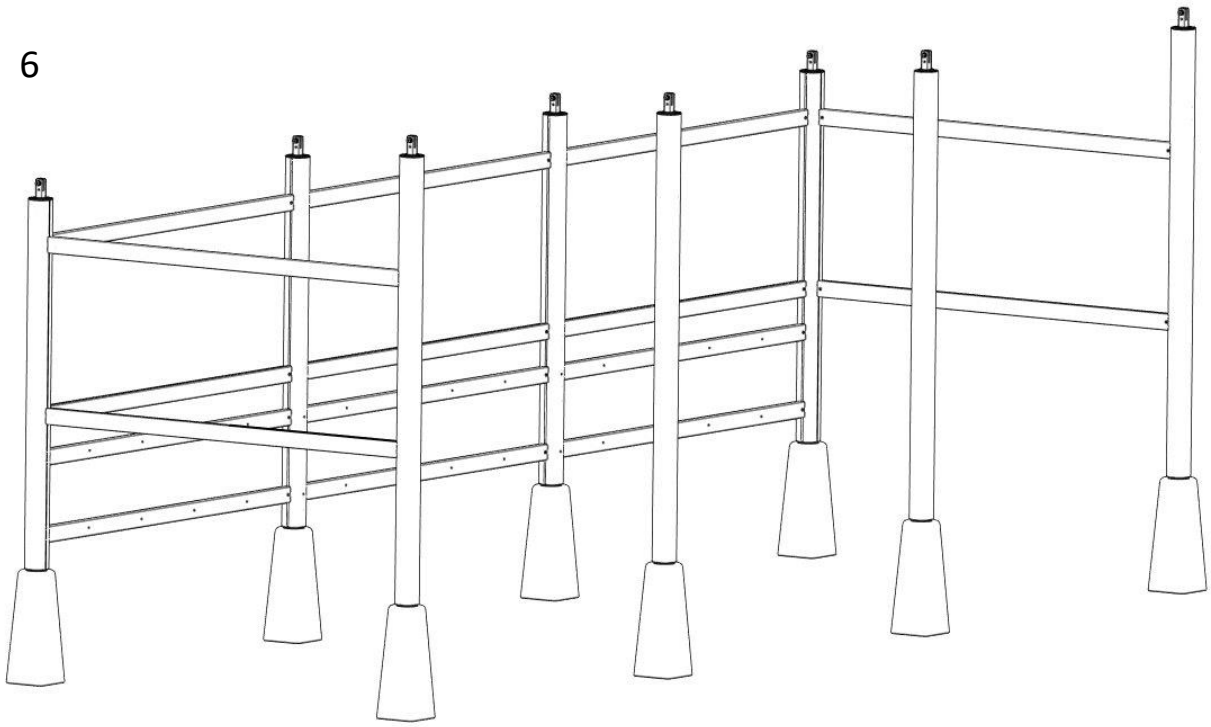

4,8x40

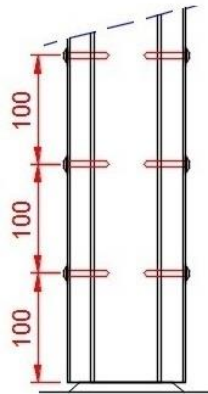
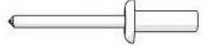

Ø5mm



7

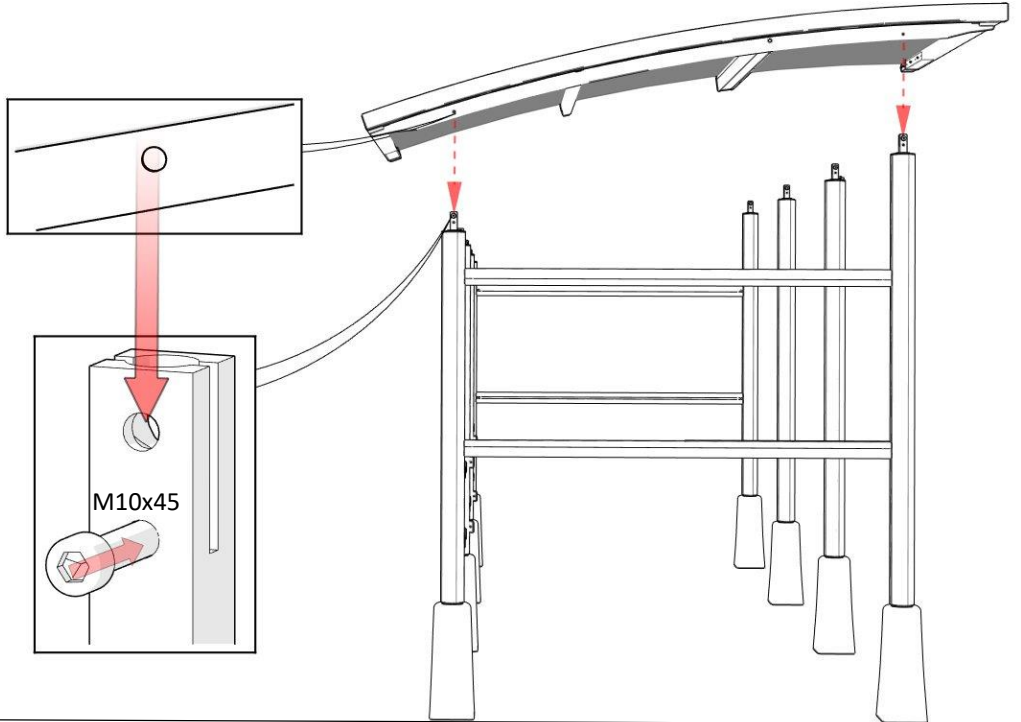
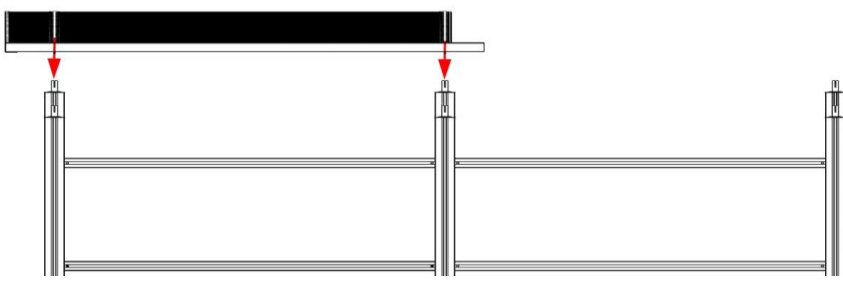

8

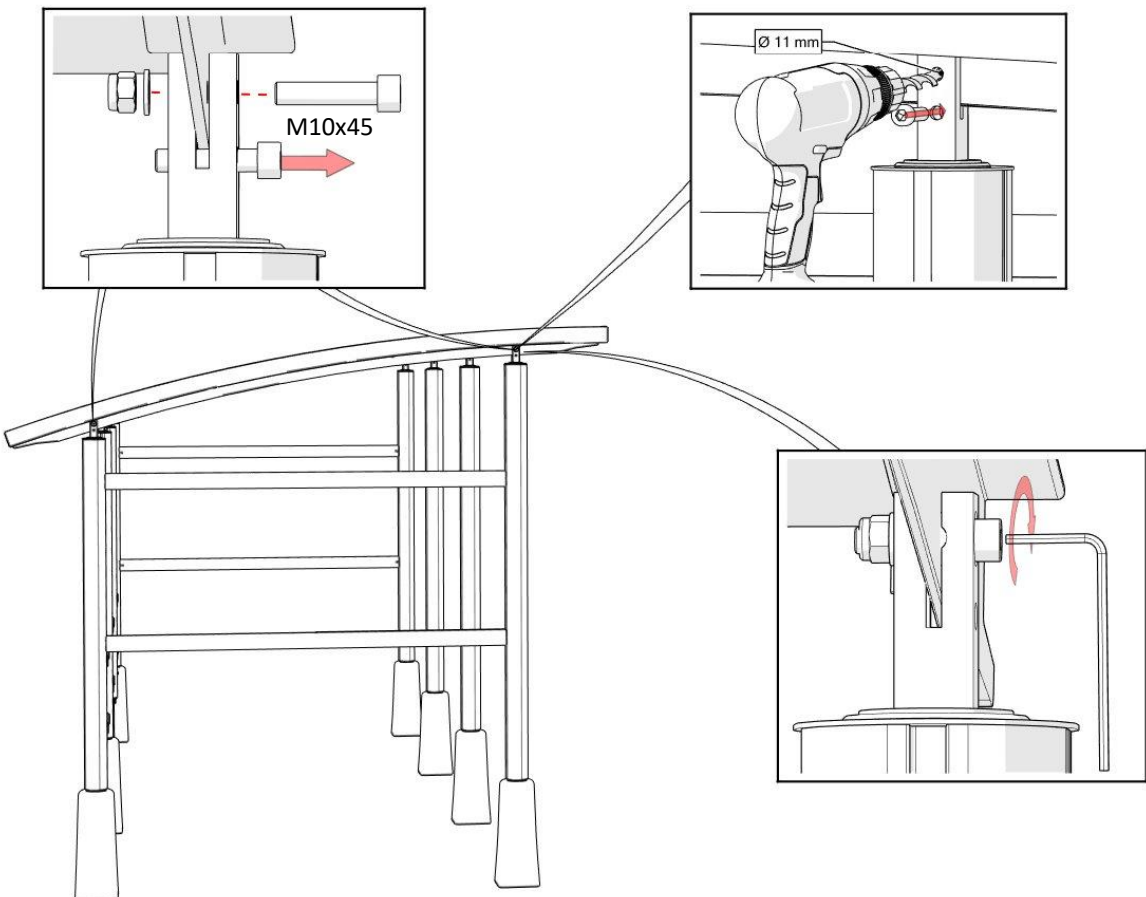

9

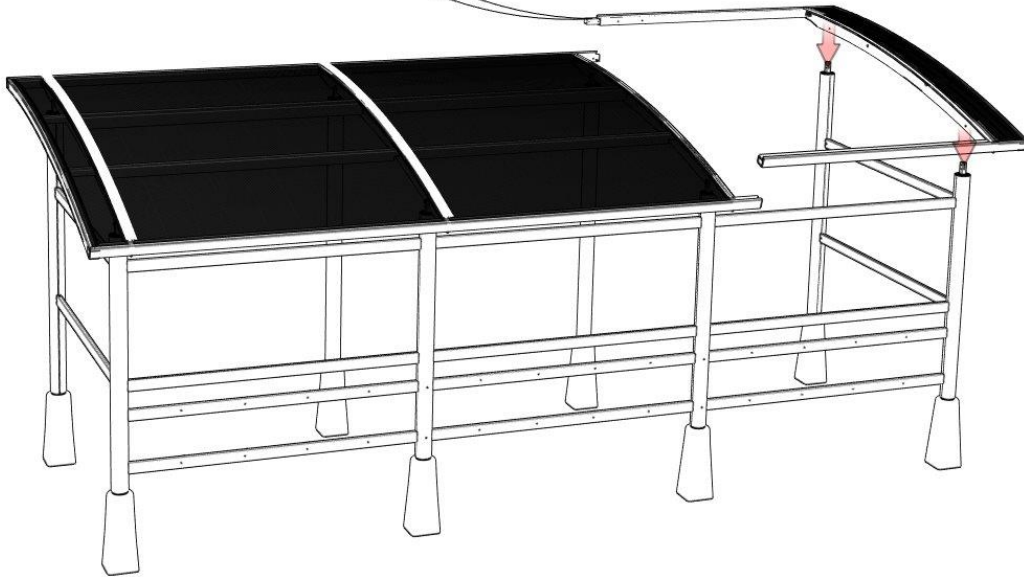
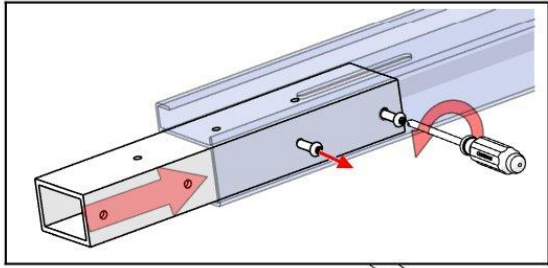

10

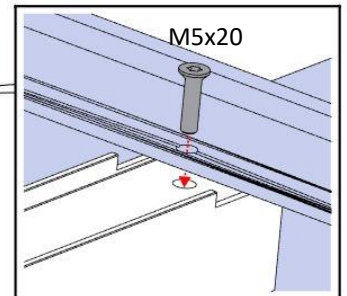
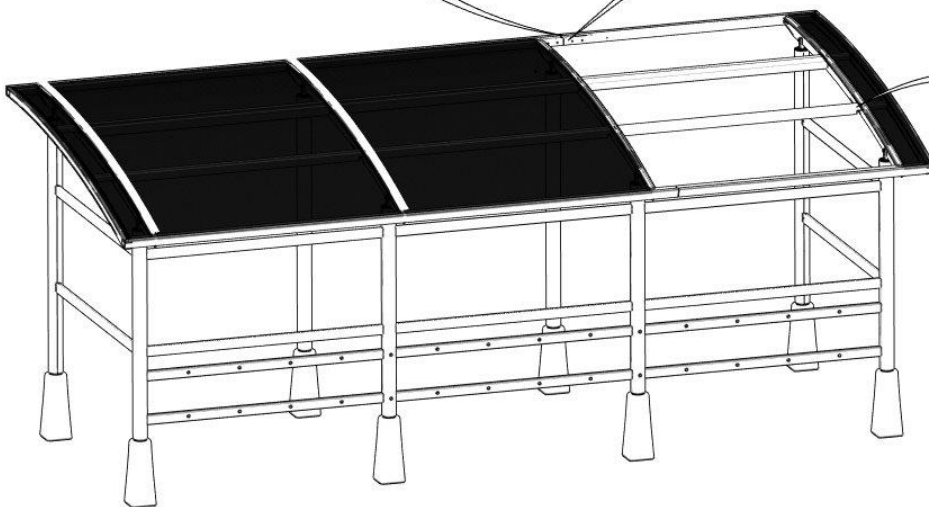
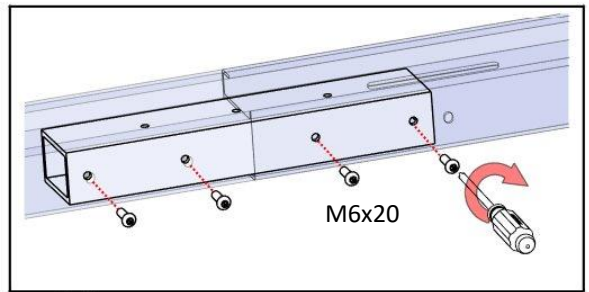
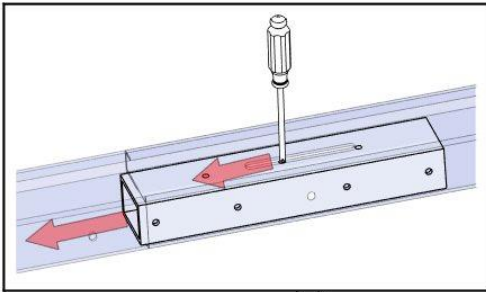

Bei Verwendung LED-
Beleuchtung siehe
nächste Seite

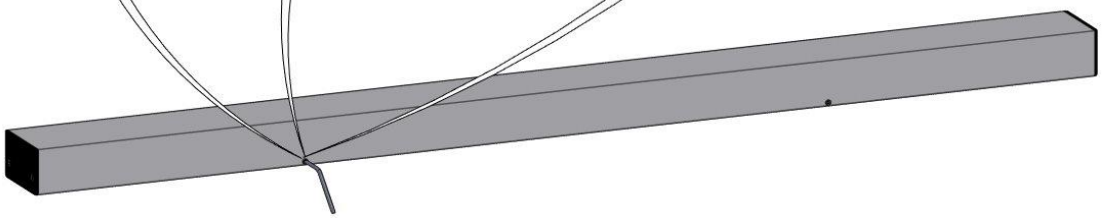
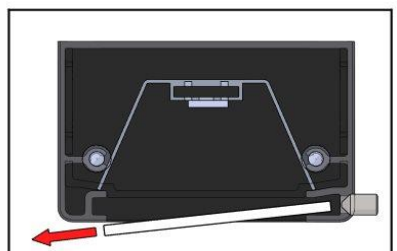
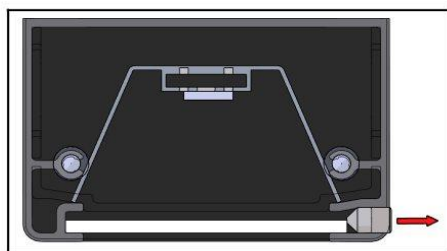
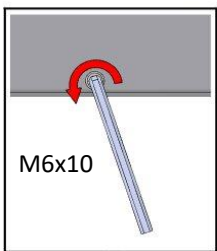
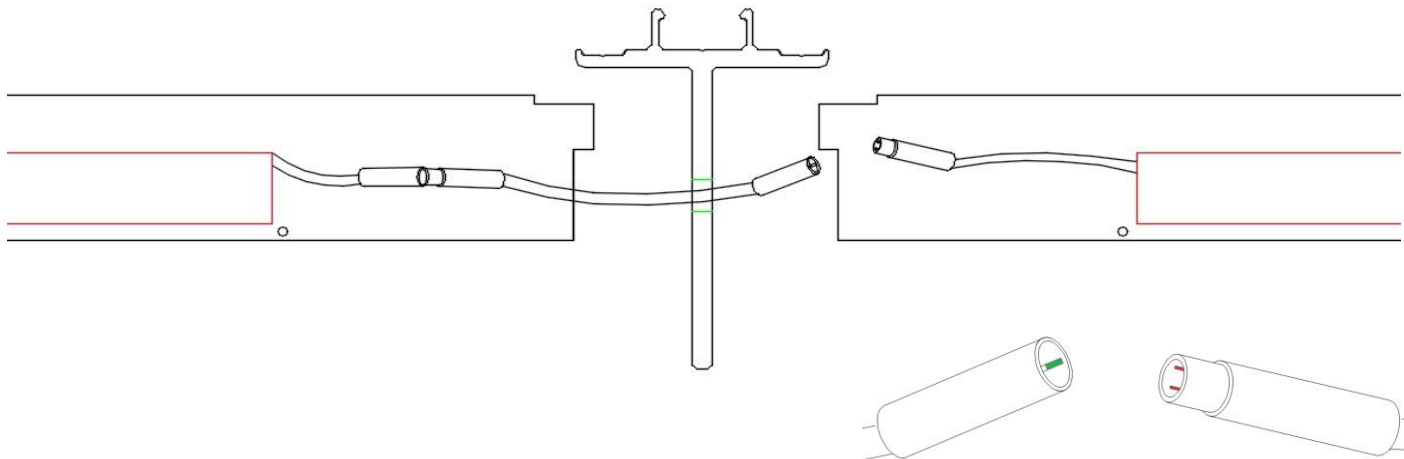
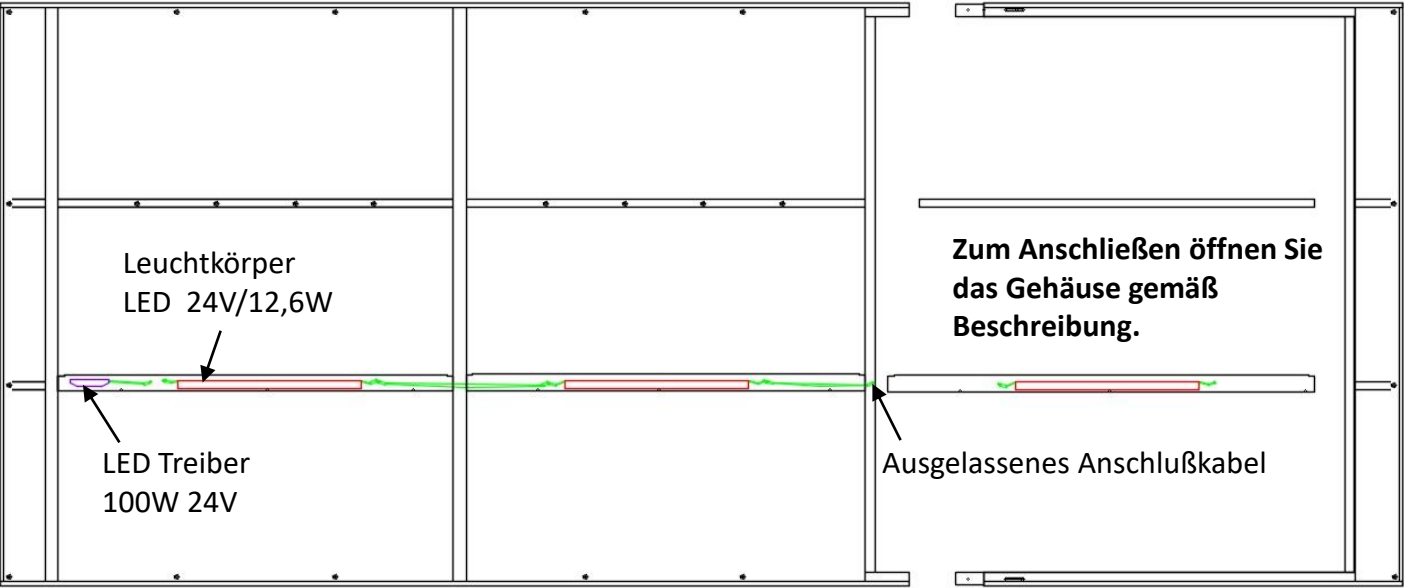

11

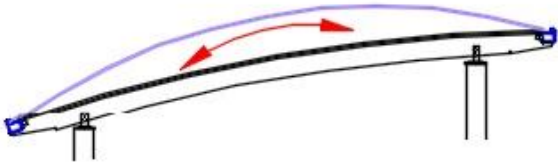
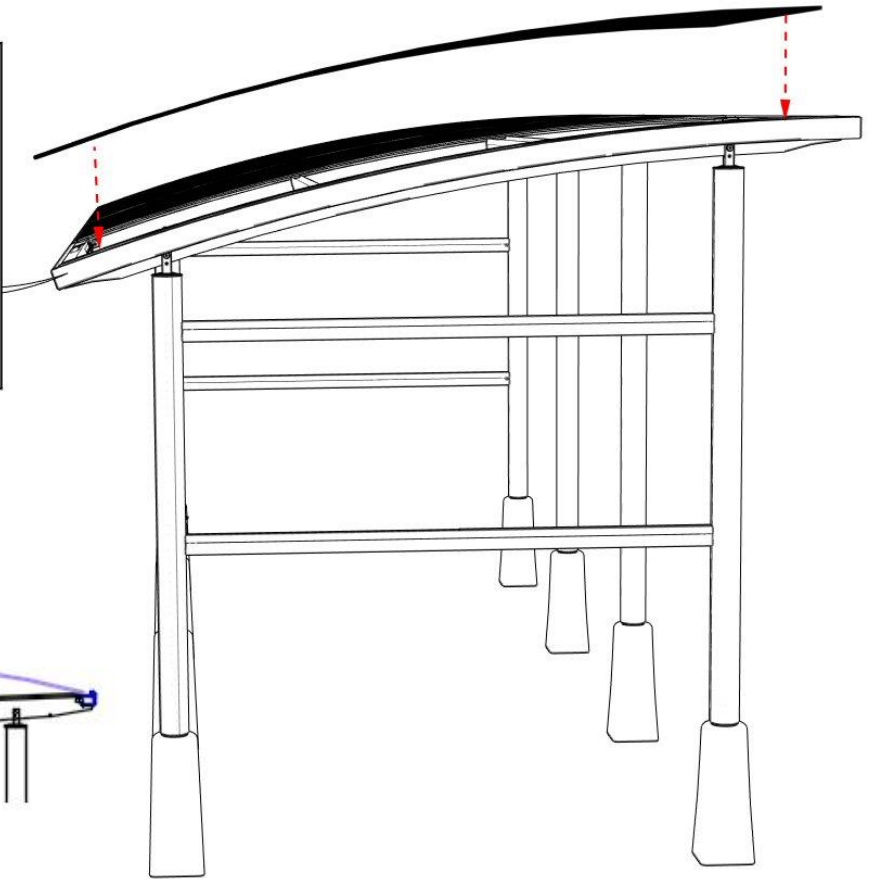
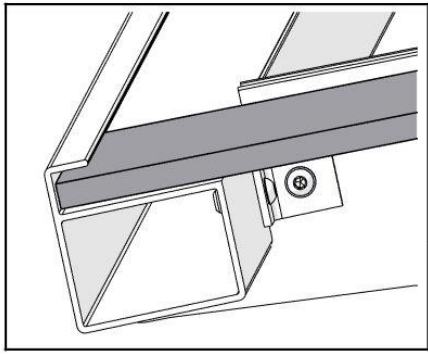

12

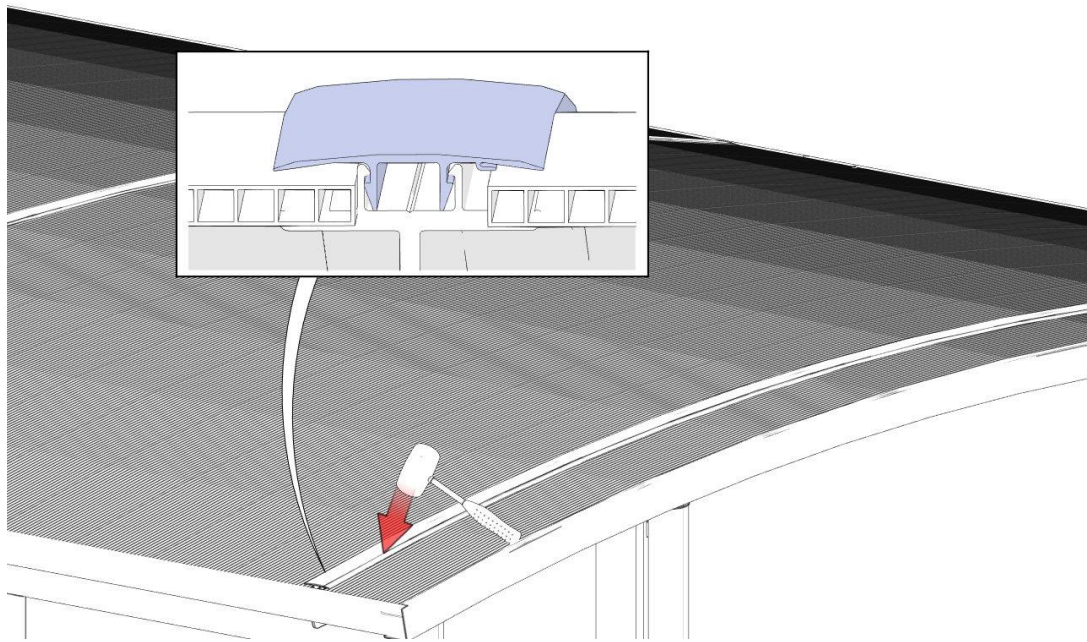
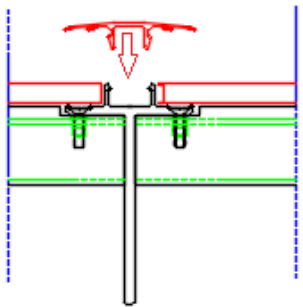

13

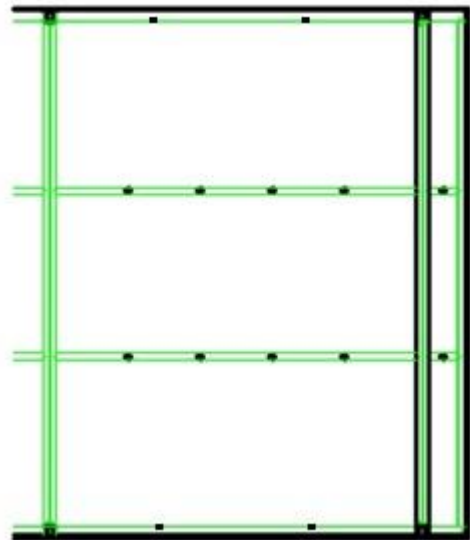
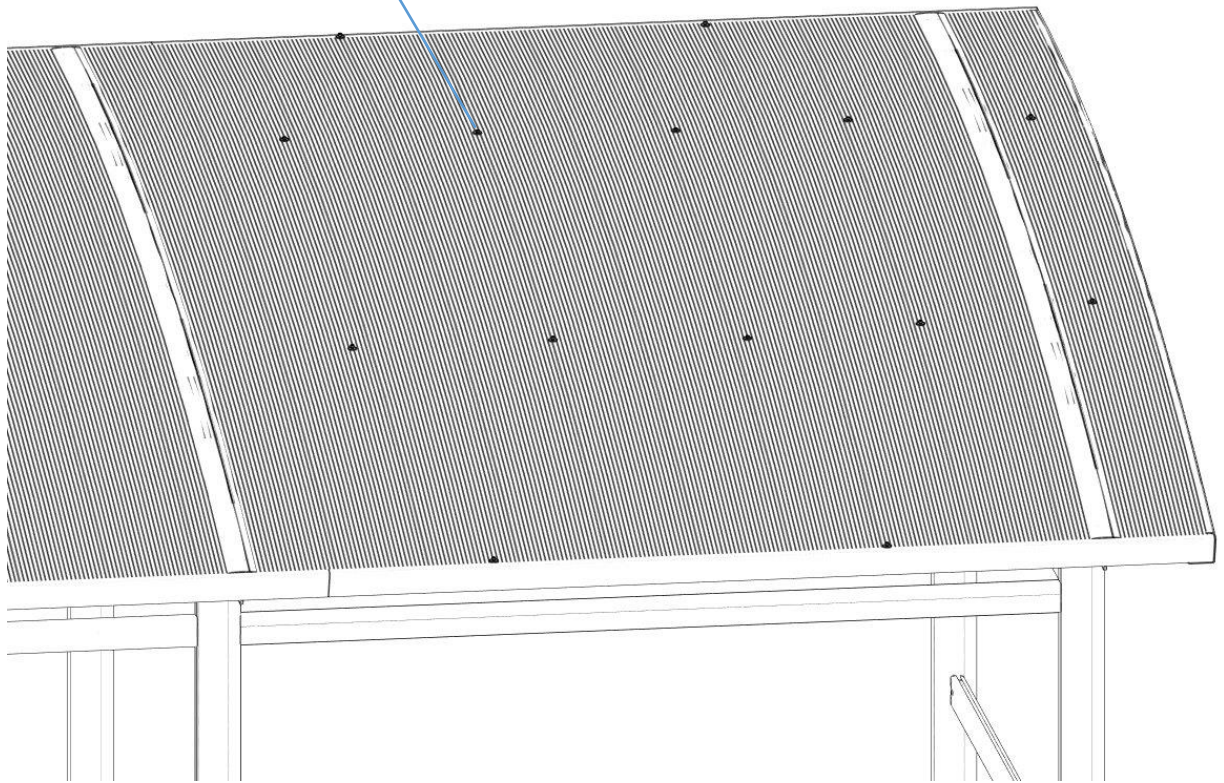
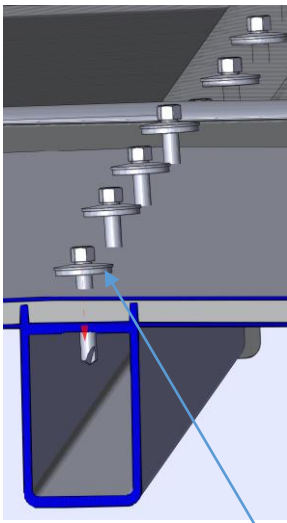

14

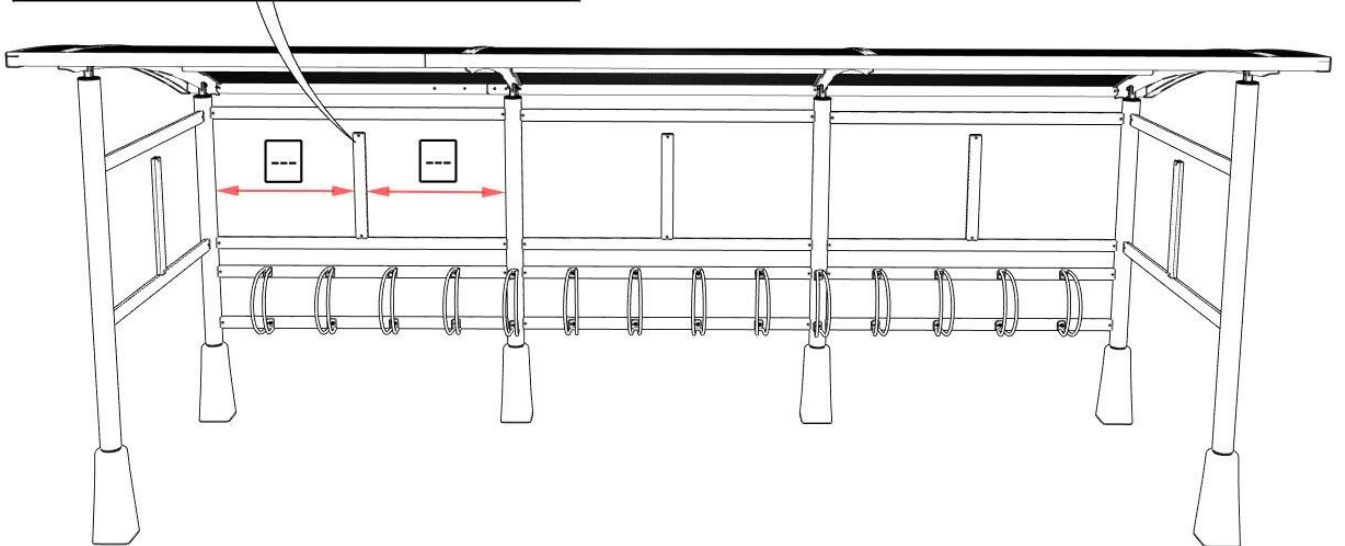
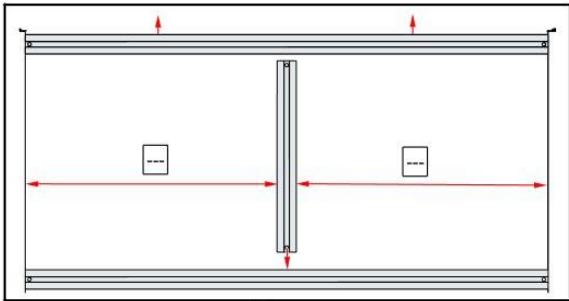
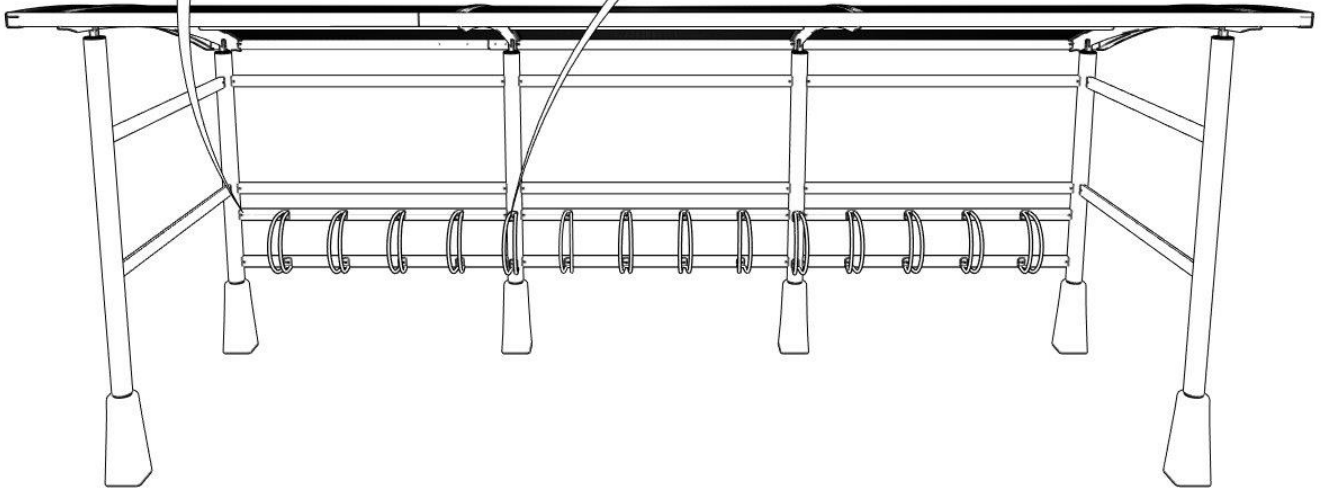
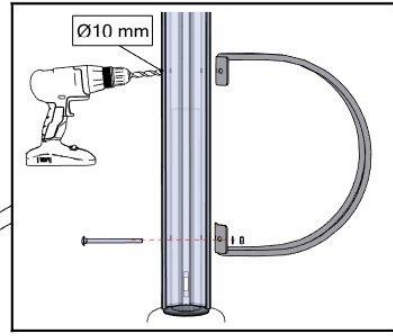
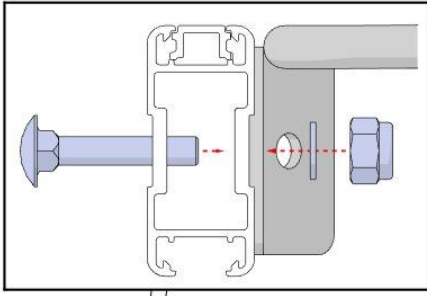

16

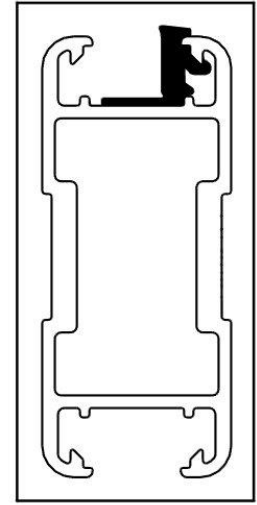
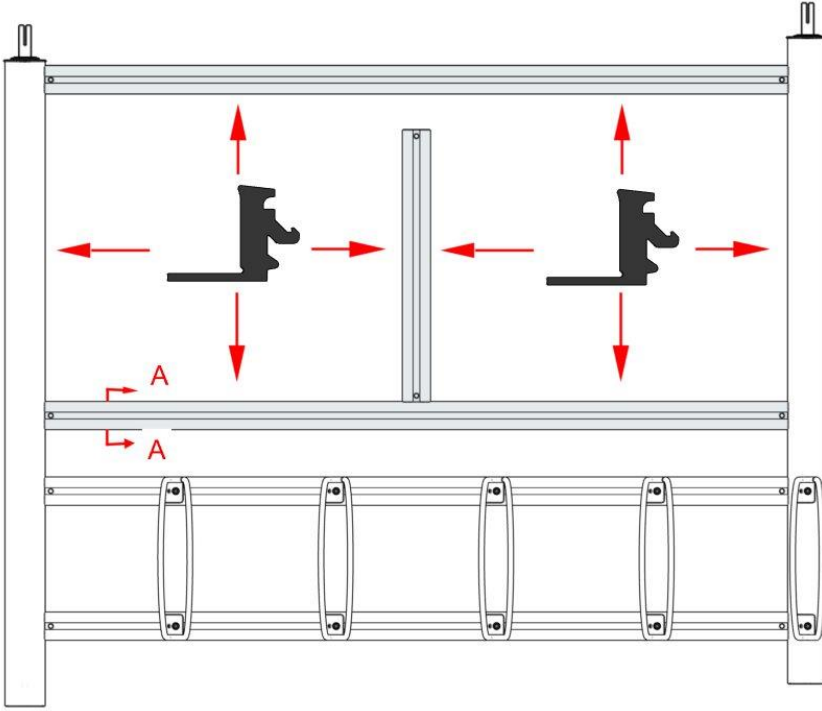

A-A

17a

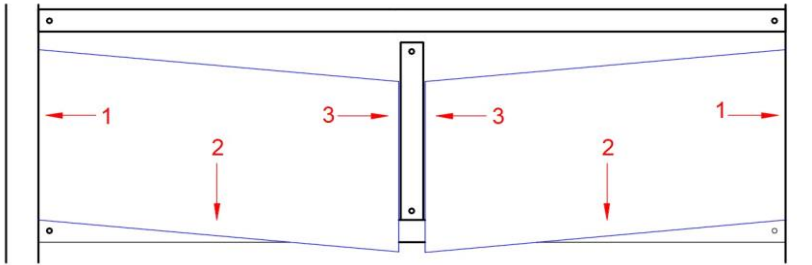

Bei Ausführung gem. Darstellung 17c kann die Gummidichtung mit Wasser und Seife zur Montage leichtgängiger gemacht werden .

17b

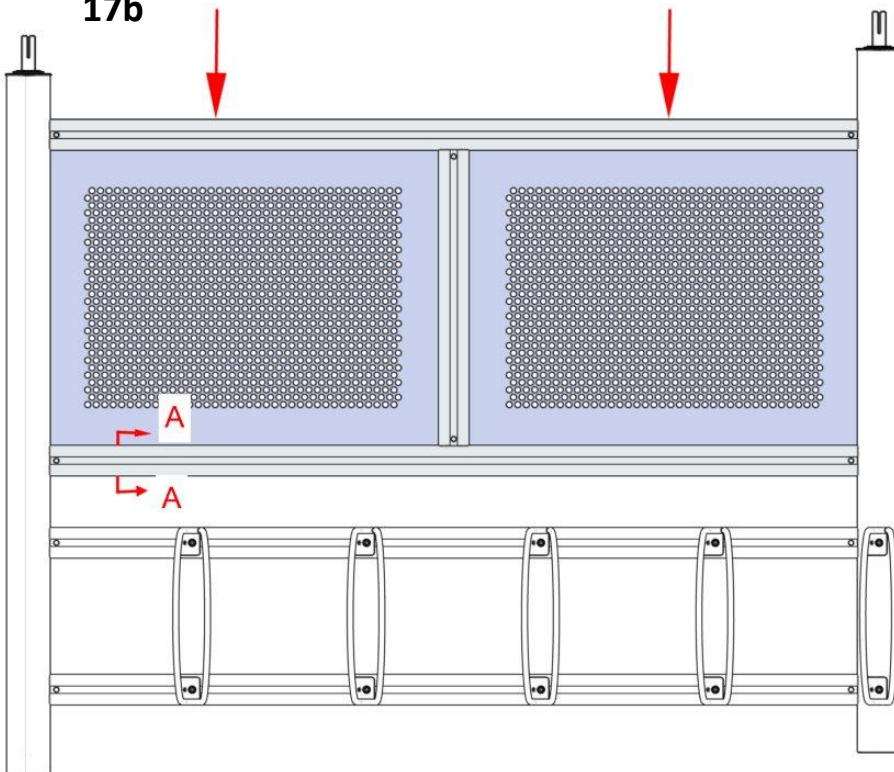

17c

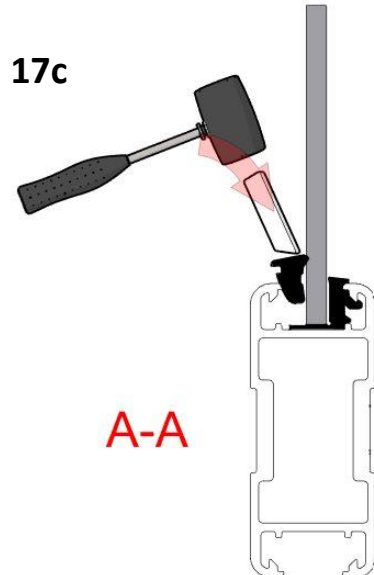

A-A

